

STEEL END SECTIONS FOR PIPE-ARCH

Dimensions of Galvanized Steel End Sections for Pipe-Arch 2 3/4 x 1/2 in. Corrugations

Span x Rise (in.)	Equip/Round (in.)	Specified Thickness (in.)	A Min. (in.)	B Max. (in.)	H Min. (in.)	F Min. (in.)	L ± 2 (in.)	Max Width (in.)	W	Approximate End Section Slope*
17 x 13	15	0.064	5	9	6	28	20	52	52	2 1/8
21 x 15	18	0.064	6	11	6	34	24	58	58	2
24 x 18	21	0.064	7	12	6	40	28	63	63	2 1/8
28 x 20	24	0.064	7	16	6	46	32	70	70	2
35 x 24	30	0.079	9	16	6	58	39	85	85	1 7/8
42 x 29	36	0.079	11	18	7	73	46	104	104	1 7/8
49 x 33	42	0.109	12	21	9	82	53	117	117	1 3/4
57 x 38	48	0.109	16	26	12	88	62	132	132	1 7/8
64 x 43	54	0.109	17	30	12	100	69	144	144	1 7/8
71 x 47	60	0.109	17	36	12	112	77	156	156	1 7/8
77 x 52	66	0.109	17	36	12	124	77	167	167	1 5/8
83 x 57	72	0.109	17	44	12	130	77	177	177	1 1/2

*Fill slope need not match the end section slope. Fill can be shaped at each site to fit.

1. Some larger sizes may require field assembly.
2. Optional toe plates may be provided to depths specified.

Dimensions of Galvanized Steel End Sections for Pipe-Arch, 3 x 1 in. and 5 x 1 in. Corrugations

Span x Rise (in.)	Equip/Round (in.)	Specified Thickness (in.)	A Min. (in.)	B Max. (in.)	H Min. (in.)	F Min. (in.)	L ± 2 (in.)	Max Width (in.)	W	Approximate End Section Slope*
53 x 41	48	0.109	17	26	12	88	63	130	130	1 3/4
60 x 46	54	0.109	17	36	12	100	70	142	142	1 7/8
66 x 51	60	0.109	17	36	12	112	77	156	156	1 3/4
73 x 55	66	0.109	17	36	12	124	77	168	168	1 1/2
81 x 59	72	0.109	17	44	12	136	77	179	179	1 5/8
87 x 63	78	0.109	17	44	12	136	77	186	186	1 1/2
95 x 67	84	0.109	17	44	12	160	87	210	210	1 1/2
103 x 71	90	0.109	17	44	12	172	87	222	222	1 1/2
112 x 75	96	0.109	17	44	12	172	87	226	226	1 1/4

*Fill slope need not match the end section slope. Fill can be shaped at each site to fit.

1. Some larger sizes may require field assembly.
2. Optional toe plates may be provided to depths specified.

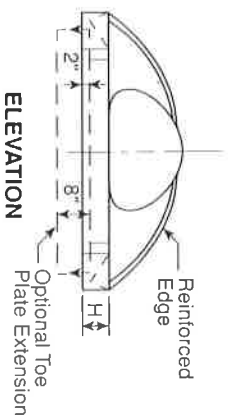
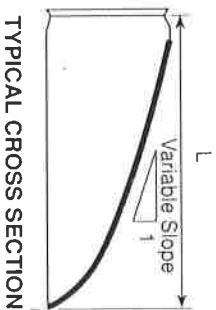
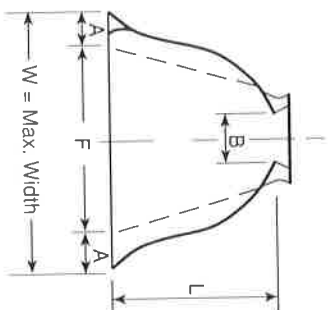

STREGIS
CULVERT INC.